

HERSEY FRP

HERSEY FRP II

SIZE

Model FRP 3/4"-1"

Model FRP II 3/4", 1", 1 1/4", 1 1/2", 2"

DESCRIPTION

This model is a reduced pressure assembly. Production was begun approximately in 1975 and was discontinued in 2004. You will notice there is a FRP & FRP II in the 3/4" and 1" sizes. The model FRP was the first introduction of this model and revisions were made which lead to the FRP II series and expansion of the sizes from 3/4"-2". The body is made of bronze. The check valve modules in both models are the same. The only difference in the FRP II is the shape of the relief valve component. The model FRP has a rectangular shape diaphragm with the relief valve section on the bottom pointing downward. The FRP II has a circular shape diaphragm pointing outward in line with the piping. All internal hardware parts are made mostly of glass filled noryl plastic. The checks are modular in construction. All seats are replaceable. A relief valve seat tool is needed to change the relief valve seat. All springs are contained when the covers are removed. The relief valve utilizes an internal sensing line.

BASIC REPAIR KIT

Rubber repair kit contains all rubber discs, O-rings, quad ring, diaphragm, mounting screws, and gasket

<u>SIZE</u>	<u>KIT NO</u>	<u>AIR GAP DRAIN</u>
FRP 3/4"-1"	65554 ♦	N/A
FRP II 3/4"-1"	65668	65639
1 1/4"-1 1/2"	65669	65640
2"	65670	65640

IMPORTANT FEATURES

- ~Bronze body
- ~Modularized checks
- ~Contained springs
- ~Replaceable seats

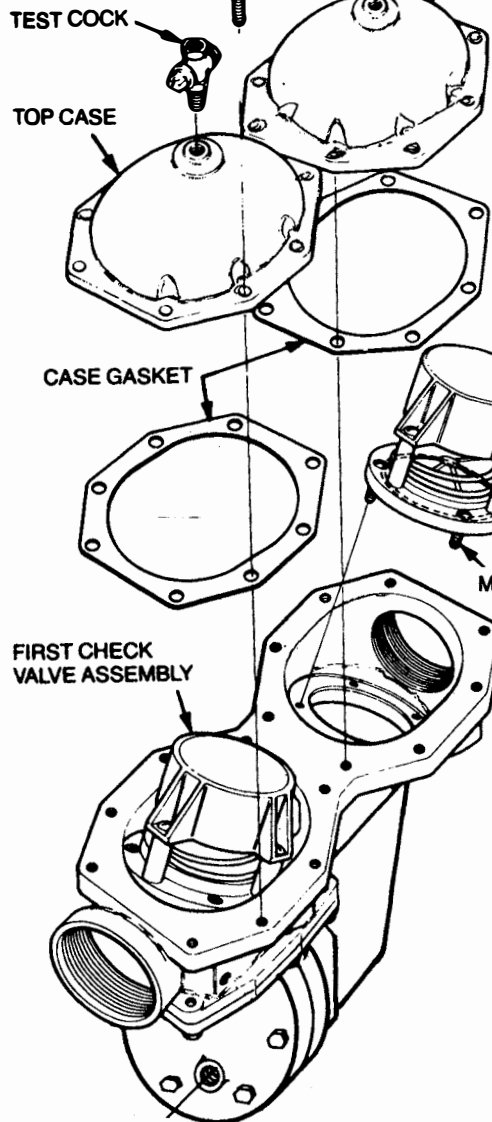

1 1/4", 1 1/2" AND 2" FRP II REPLACEMENT PARTS

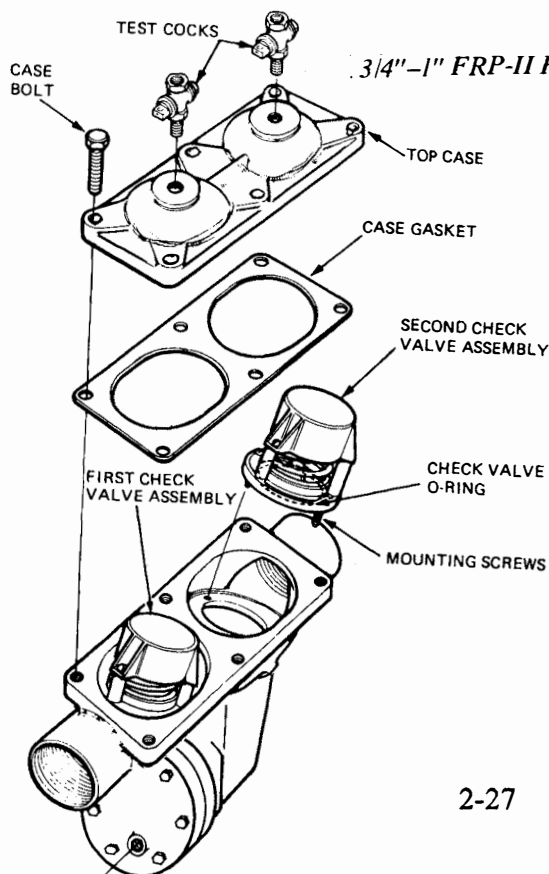
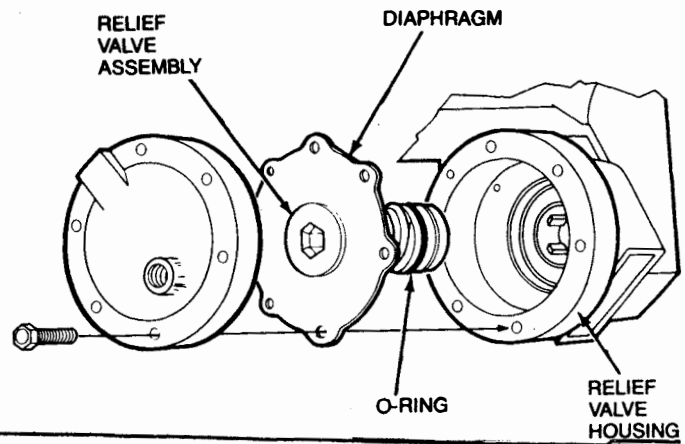
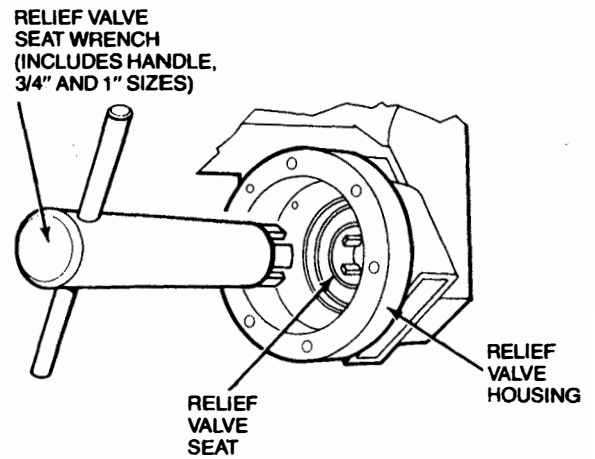

3/4"-1" FRP-II REPLACEMENT PARTS

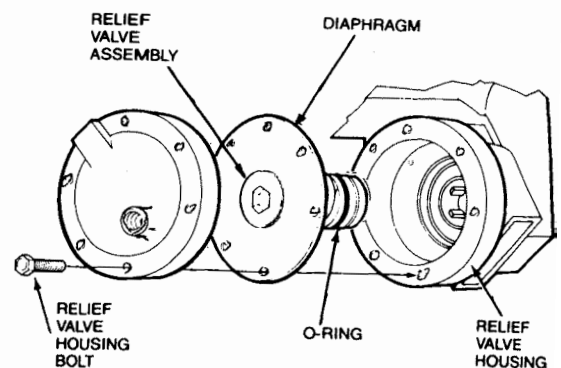
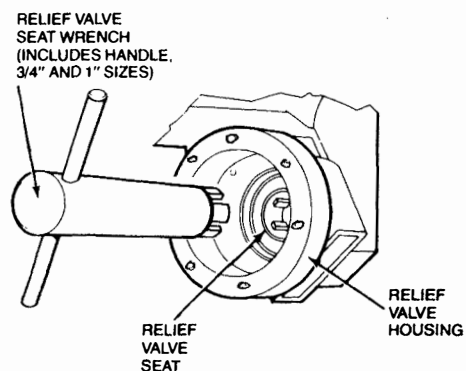

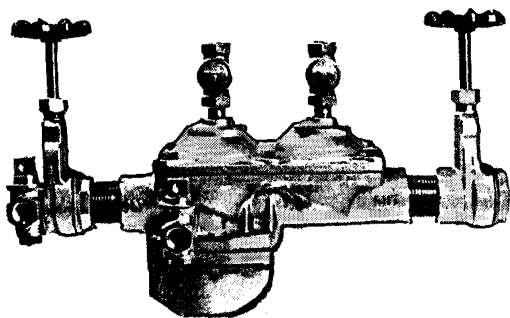

Hersey
PRODUCTS INC.

BEECO[®] MODEL FRP

SIZES 3/4" and 1"

Dimensions and Weights

Size	3/4"	1"
End Detail	Screwed	Screwed
Rated GPM*	30	50
A	12-7/8	12-3/4
B	8-3/4	8-1/8
C	7-1/2	7-7/8
D	4-13/16	5-3/16
E	4-1/16	4-13/16
Width	5"	5"
Size of test cocks	1/4	1/4
Net Wt. no Valves	9-3/4 lbs.	9-1/4 lbs.
Net Wt. with Valves	11-3/4 lbs.	12 lbs.
Gross Wt. no Valves	10-1/2 lbs.	10 lbs.
Gross Wt. with Valves	13 lbs.	13-3/4 lbs.

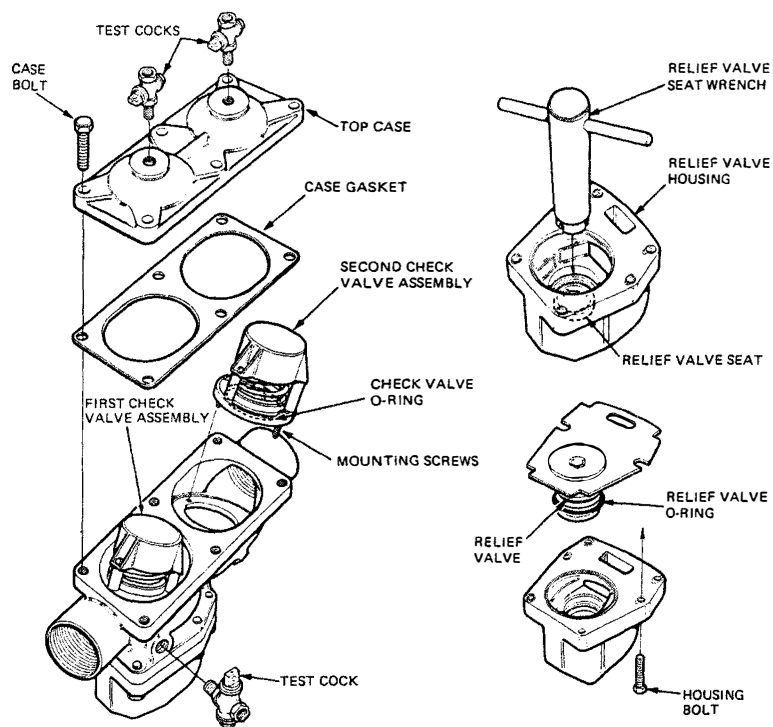
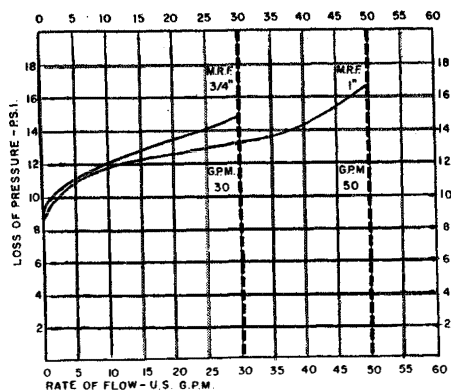
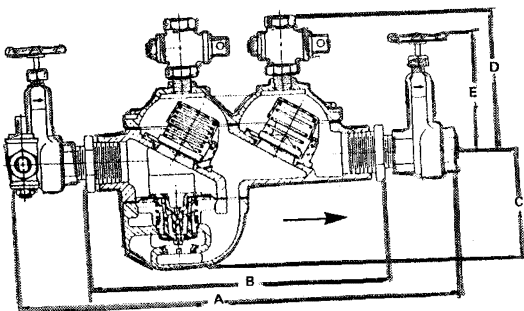

3/4" AND 1" REPLACEMENT PARTS

FRP 1¼", 1½" and 2" FRP-II REPLACEMENT PARTS

If more than one part per unit is required, quantity is indicated in parentheses after part number.

	Part No. 1¼", 1½"	Part No. 2"
COMPLETE VALVE KIT		
Includes:	65525	65543
First Check Valve Assembly		
Second Check Valve Assembly		
Relief Valve Assembly		
Case Gaskets (2)		
Check Valve O-rings (2)		
Relief Valve O-ring		
Check Valve Mounting Screws (8)		
FIRST CHECK VALVE KIT	65526	65544
Includes:		
First Check Valve Assembly		
Check Valve O-ring		
Case Gasket		
Mounting Screws (4)		
SECOND CHECK VALVE KIT	65527	65545
Includes:		
Second Check Valve Assembly		
Check Valve O-ring		
Case Gasket		
Mounting Screws (4)		
RELIEF VALVE KIT	65546	65546
Includes:		
Relief Valve		
O-Ring Seal		
RELIEF VALVE SEAT INSTALLATION KIT	65548	65548
Includes:		
Relief Valve Seat		
Relief Valve Seat Wrench		
Relief Valve Adhesive/Sealant		

BASIC REPAIR KIT

Rubber repair kit contains all rubber discs, O'rings, quad ring, diaphragm, mounting screws, and gasket

<u>SIZE</u>	<u>KIT NO</u>
1 1/4"-1 1/2"	65669
2"	65670

	Part No. 1¼", 1½"	Part No. 2"
OTHER PARTS		
Relief Valve Cover	65632	65632
Top Case	65560(2)	65578(2)
Bottom Case	65631	65636
Case Bolts	90028(18)	90028(22)
Test Cocks	96339(3)	96339(3)
Check Valve Spring Compression Tool	65572	65572
Check Valve Mounting Screws	98174(8)	98174(8)
1½" x 1¼" Reducing Bushing (1¼" only)	67016(2)	-----
Case Gasket	65568(2)	65595(2)

FRP**3/4" AND 1" REPLACEMENT PARTS****Part No.****3/4"-1"****COMPLETE VALVE KIT — FRP I
FRP II****65554****65627****Includes:**

First Check Valve Assembly
 Second Check Valve Assembly
 Relief Valve Assembly
 Case Gasket
 Check Valve O-rings (2)
 Relieve Valve O-ring
 Check Valve Mounting Screws (4)

RELIEF VALVE AIR GAP FITTING KIT 65639**RELIEF VALVE SEAT
INSTALLATION KIT****65524****Includes:**

Relief Valve Seat
 Relief Valve Seat Wrench
 Relieve Valve Adhesive/Sealant

FIRST CHECK VALVE KIT**65555****Includes:**

First Check Valve Assembly
 Check Valve O-ring
 Case Gasket
 Mounting Screws (2)

SECOND CHECK VALVE KIT**65556****Includes:**

Second Check Valve Assembly
 Check Valve o-ring
 Case Gasket
 Mounting Screws (2)

**RELIEF VALVE KIT — FRP I
FRP II****65557****65628****Includes:**

Relief Valve
 O-ring Seal

OTHER PARTS:

Relief valve cover-FRP II 65624
 Relief valve housing w/seat
 Ring-FRP I N/A
 Top case 65531
 Bottom case-FRP II 3/4" 65623
 Bottom case-FRP II 1" 65622
 Bottom case-FRP I N/A
 Case bolts -FRP I 90026 (12)
 Case bolts-FRP II 90026 (12)
 Test cocks 96339 (3)
 Check valve mounting screws 98116 (4)
 Case gasket 65534

(Figures in parentheses after part number indicate number of parts required, if more than one.)

BASIC REPAIR KIT

Rubber repair kit contains all rubber discs, O'rings, quad ring, diaphragm, mounting screws, and gasket

<u>SIZE</u>	<u>KIT NO.</u>
FRP II 3/4"-1"	65668